

New Teaching and Learning Building Event: 8th July 2014



Event programme

3pm to 3:15pm - talk from PVC Professor Lawrence Young

3:15pm to 3:30pm - talk from Estates Office and Design Team

3:30pm to 6pm - your chance to talk to the project team

New Teaching & Learning Building Strategic Objectives

The New Teaching and Learning Building will increase dedicated teaching and learning space to provide an inclusive educational environment accessible to all.

The building represents our commitment to teaching and enhancing student experience through providing a 500-seater premier lecture theatre and a variety of flexible and functional teaching rooms alongside social learning spaces.

The building will have an outstanding architectural form and be an integral part of university life and landscape. It will be adaptable to different uses, with an inspiring and welcoming environment.

It will be designed to support the application of advancing technologies enabling world class academic activity and will allow for innovative pedagogies. The building shall become the exemplar for the built form at the University of Warwick for the next 50 years.

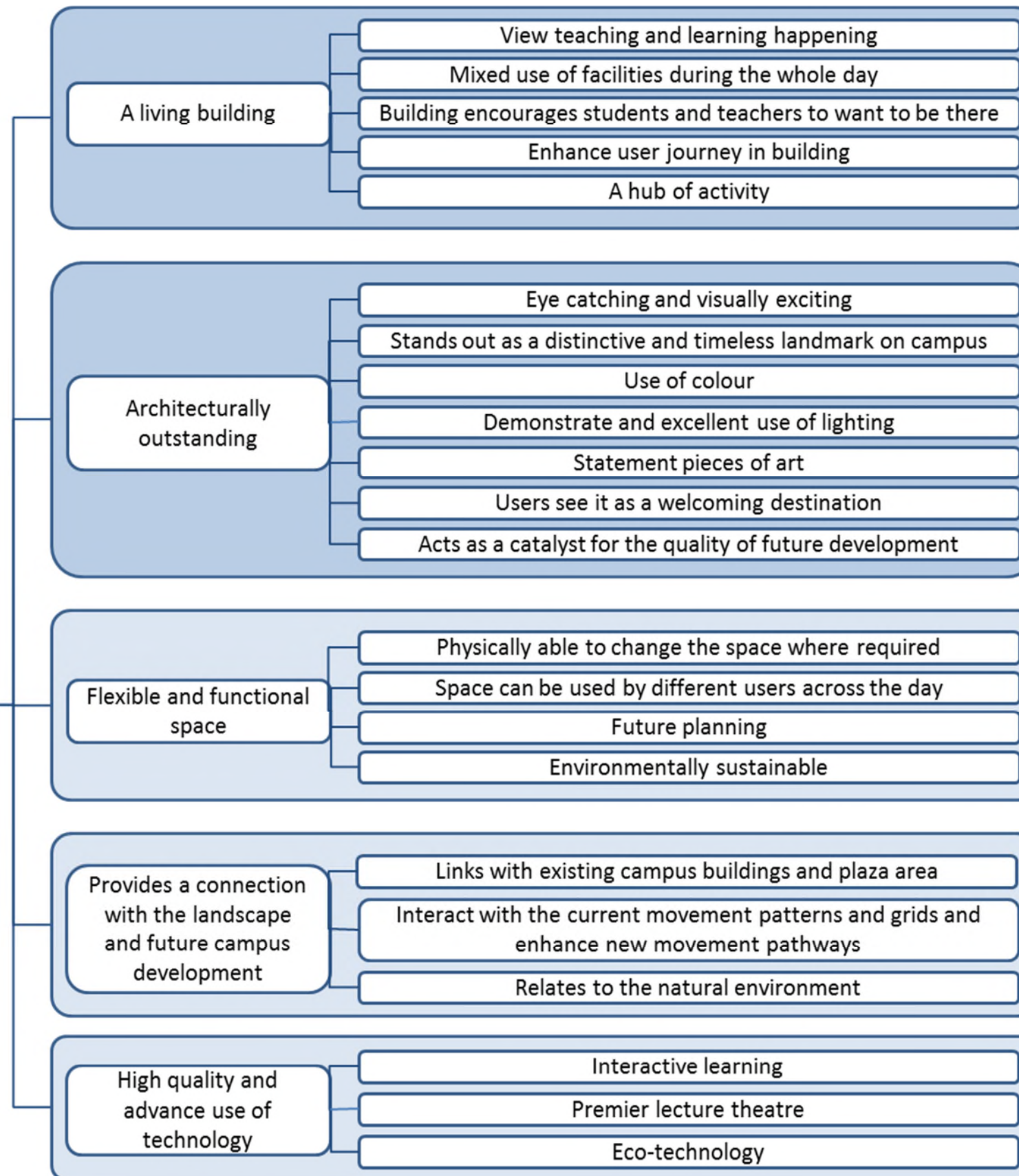

Value management workshops were undertaken to define the strategic objectives.

It is proposed that the new facility shall be designed and constructed to achieve a level of quality that “raises the bar” compared to existing buildings and their setting.

The University Master plan prioritises the Tocil Field as an important central location for academic development.

Overarching Strategic Aspiration

The New Teaching and Learning Building will increase dedicated teaching and learning space to provide an inclusive educational environment accessible to all.

The building represents our commitment to teaching and enhancing student experience through providing a 500-seater premier lecture theatre and a variety of flexible and functional teaching rooms alongside social learning spaces.

The building will have an outstanding architectural form and be an integral part of university life and landscape. It will be adaptable to different uses, with an inspiring and welcoming environment.

It will be designed to support the application of advancing technologies enabling world class academic activity and will allow for innovative pedagogies. The building shall become the exemplar for the built form at the University of Warwick for the next 50 years.

A living building

View teaching and learning happening

Mixed use of facilities during the whole day

Building encourages students and teachers to want to be there

Enhance user journey in building

A hub of activity



Architecturally
outstanding

Eye catching and visually exciting

Stands out as a distinctive and timeless landmark on campus

Use of colour

Demonstrate and excellent use of lighting

Statement pieces of art

Users see it as a welcoming destination

Acts as a catalyst for the quality of future development

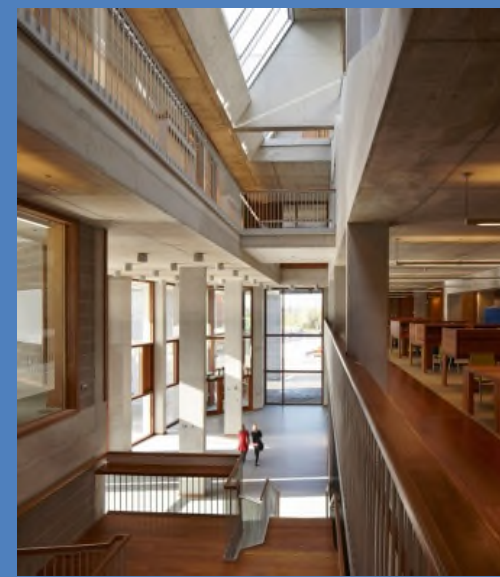
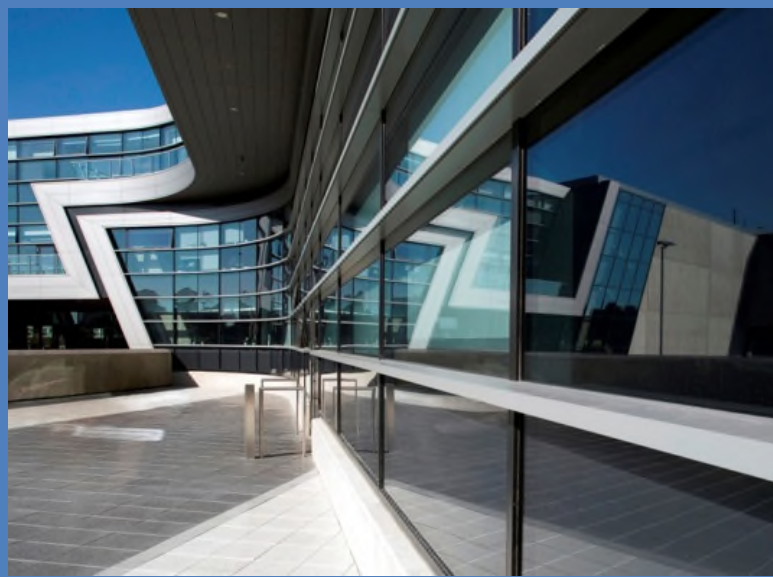

Flexible and functional
space

Physically able to change the space where required

Space can be used by different users across the day

Future planning

Environmentally sustainable



Provides a connection
with the landscape
and future campus
development

Links with existing campus buildings and plaza area

Interact with the current movement patterns and grids and
enhance new movement pathways

Relates to the natural environment



High quality and
advance use of
technology

Interactive learning

Premier lecture theatre

Eco-technology

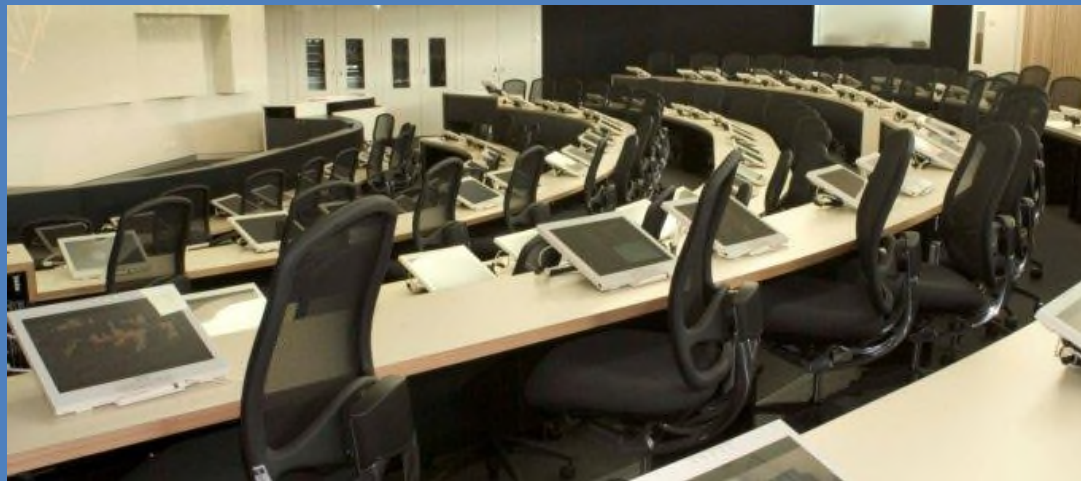
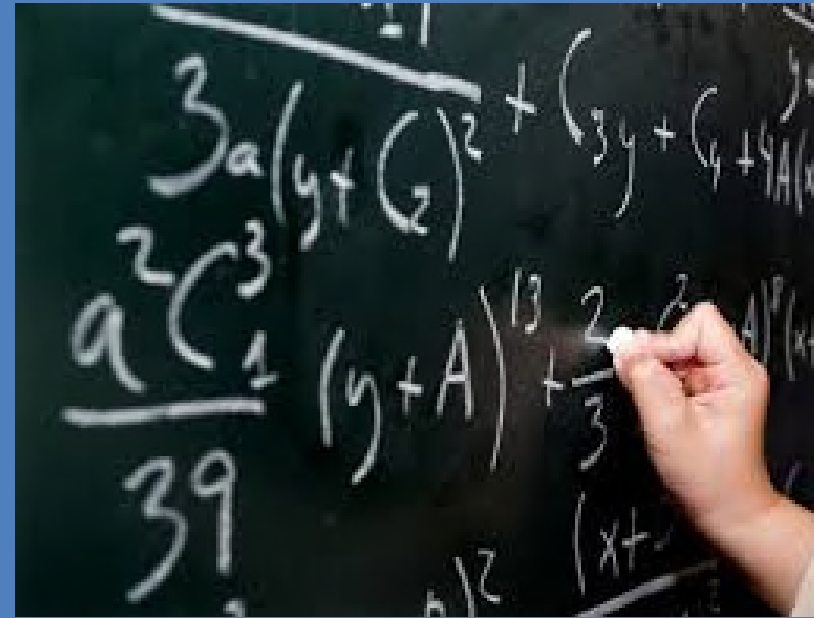

	Teaching Spaces		Seminar Rooms		Lecture Theatre	
Room Occupancy	25-30	50-60	80	100	250	500
Centrally Timetabled Rooms	5	5	1	1	1	1

Support Spaces:
 Projector rooms
 Storage
 Plant room

Communication Spaces:
 Breakout spaces/informal learning
 Café
 Circulation
 Lifts and WC's

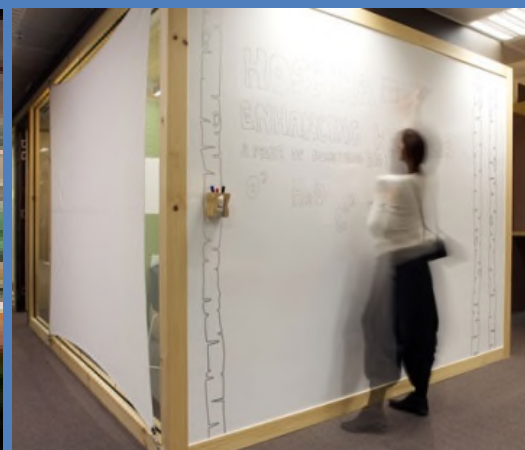

Key Dates:

Planning Application Submission – 4th Quarter 2014

Enabling Works – 4th Quarter 2014

Rooms available for use – September 2016

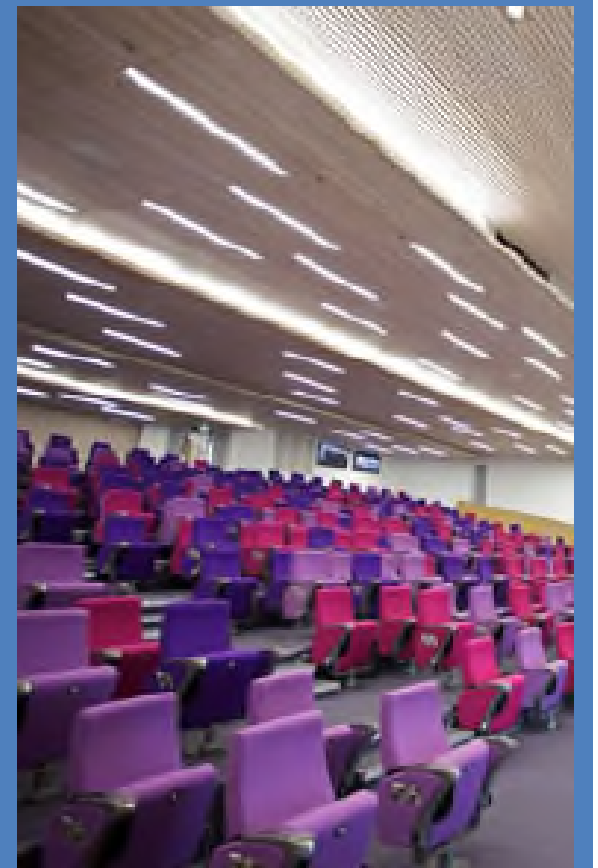
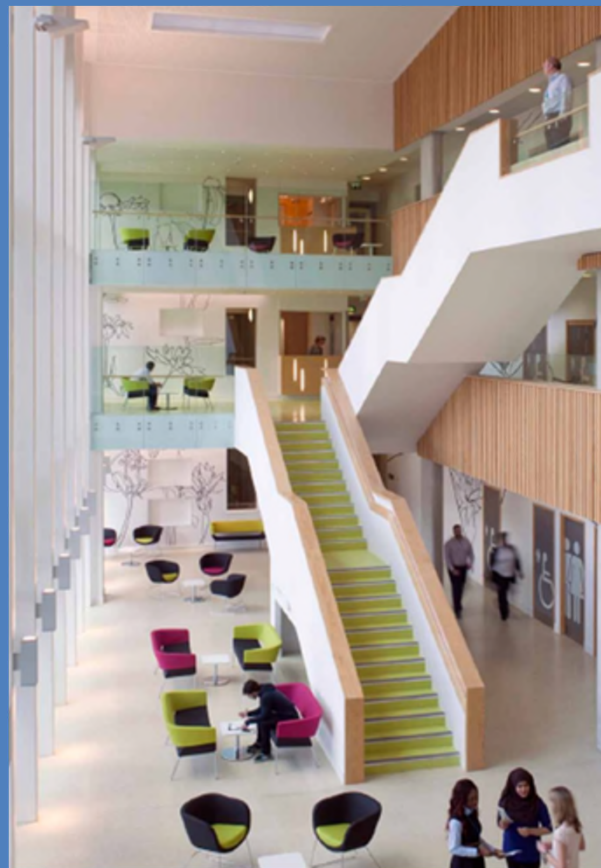

Site Analysis - 2007 Masterplan



Site Analysis - 2007 Masterplan

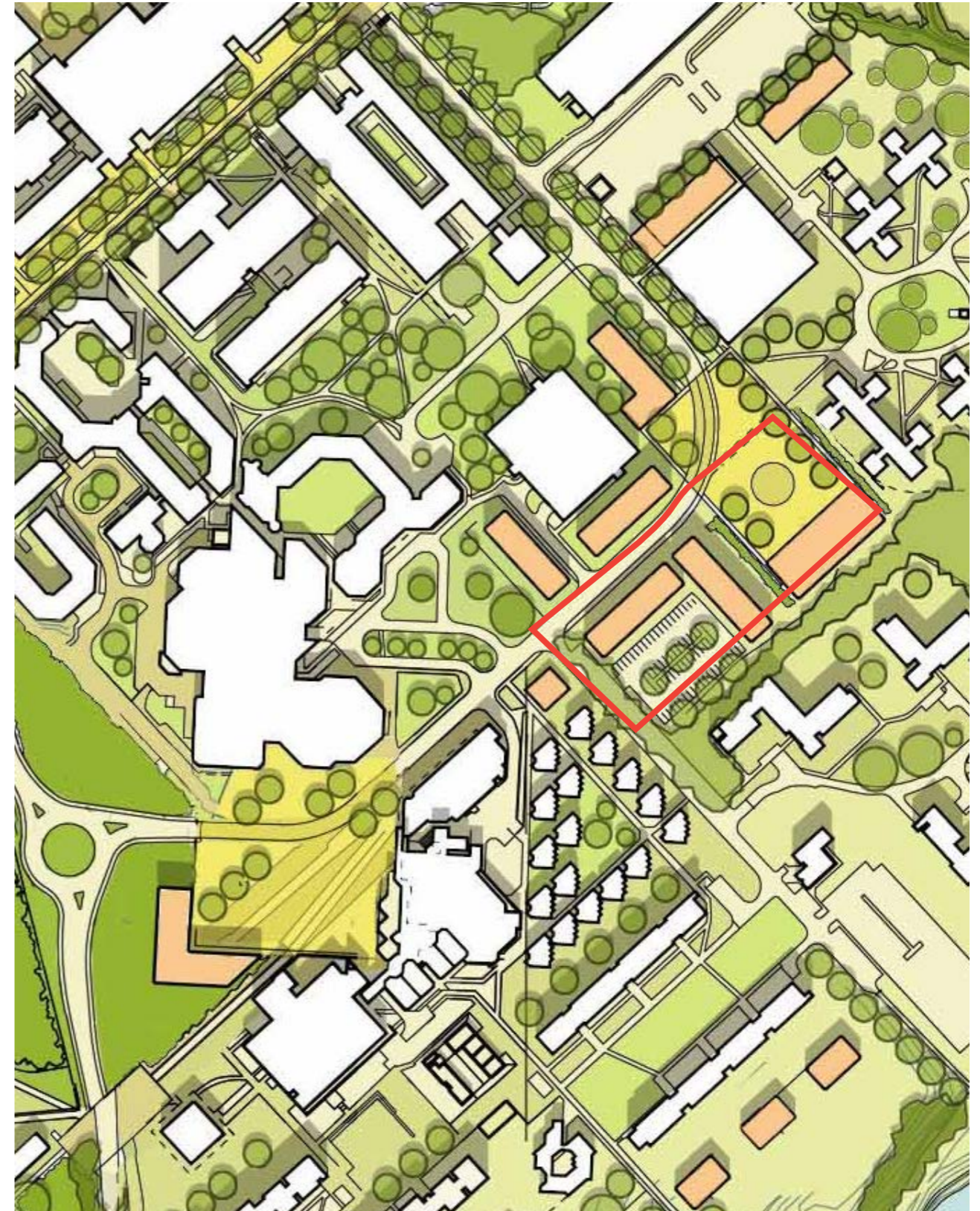
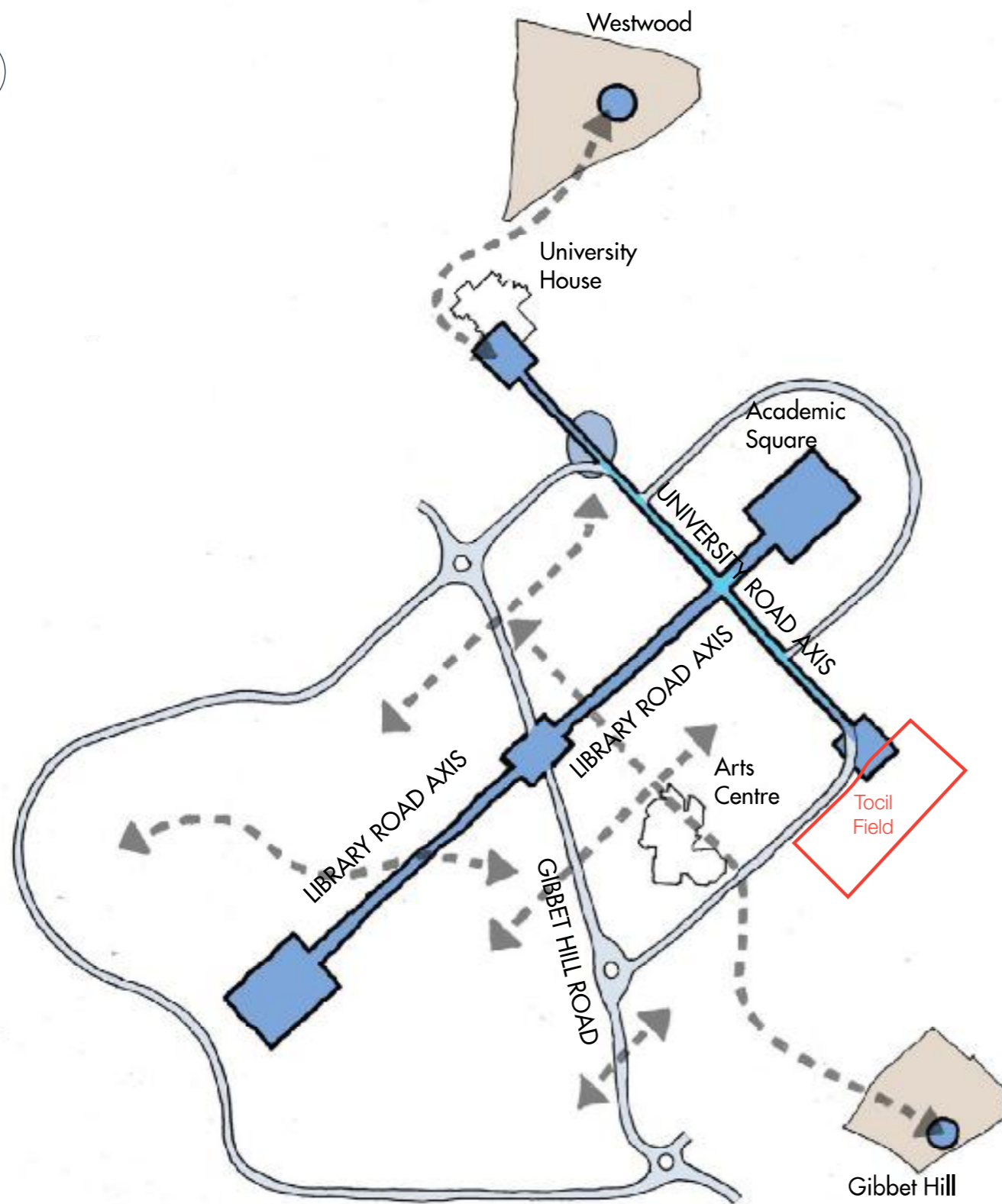

Site Analysis - Site



Site Analysis - Landscape value



Site Analysis - Vehicle and Pedestrian movement



Site Analysis - Design Option 1



- — — Site boundary
- — — Building line
- — — Central view axis
- Focal point
- Proposed landscape plaza
- Proposed new teaching building
- Proposed main lecture theatre
- Trees affected
- Pedestrian footfall

Site Analysis - Design Option 2



- Site boundary
- Building line
- - - Central view axis
- Focal point
- Landscape feature or sculpture
- Proposed landscape plaza
- Proposed new teaching building
- Proposed main lecture theatre
- Trees affected
- Pedestrian footfall

Site Analysis - Design Option 3

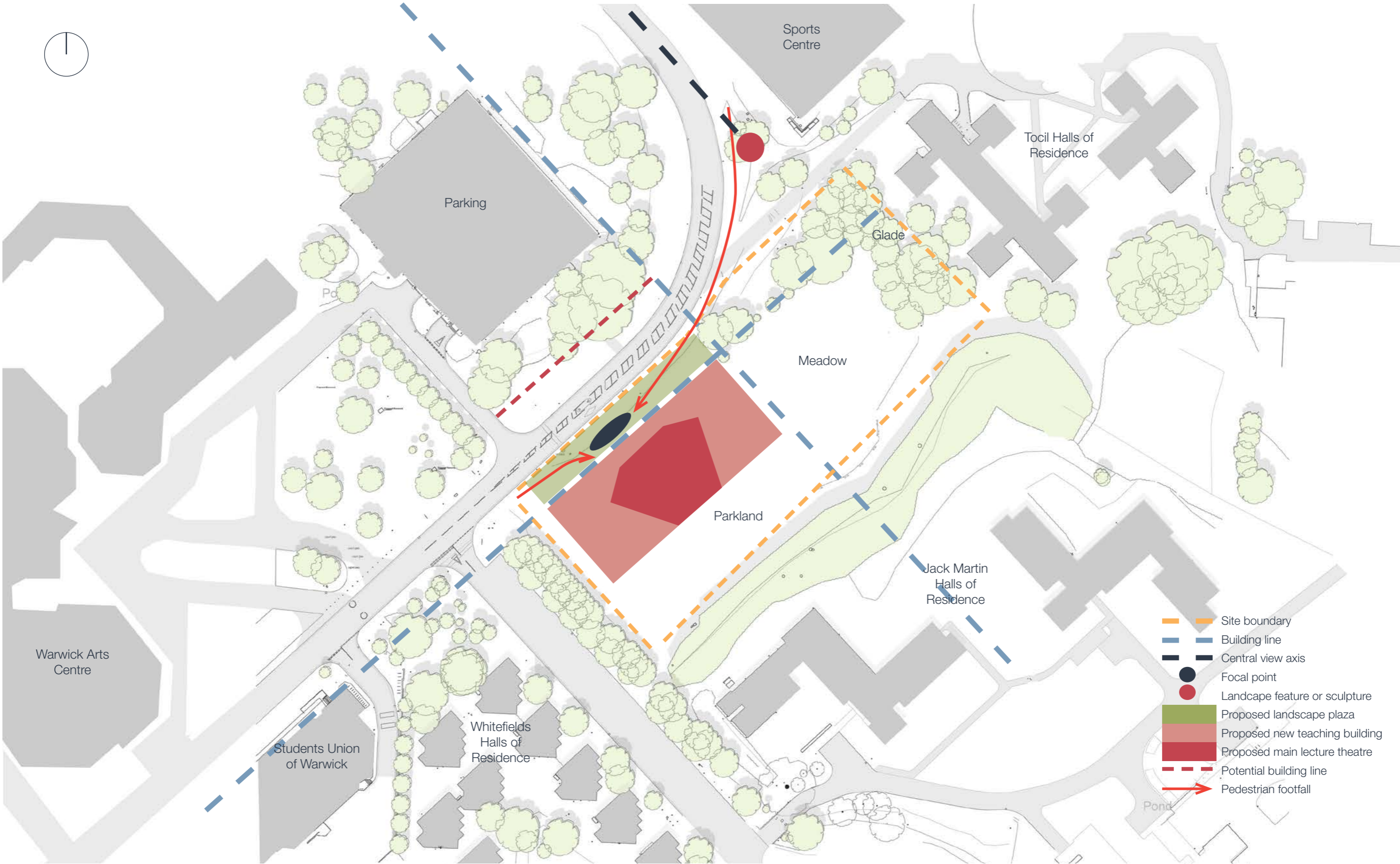

- — — — Site boundary
- — — — Building line
- - - - Central view axis
- Focal point
- Landscape feature or sculpture
- Proposed landscape plaza
- Proposed new teaching building
- Proposed main lecture theatre
- - - - Potential building line
- Pedestrian footfall

Main Lecture Theatre

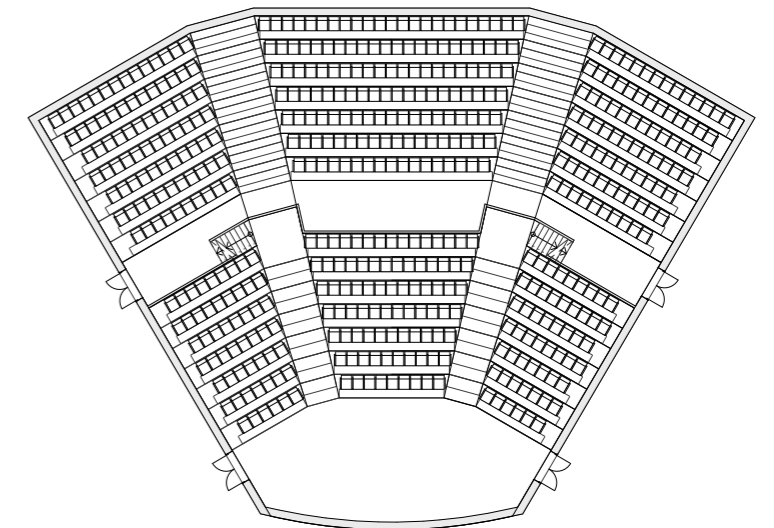
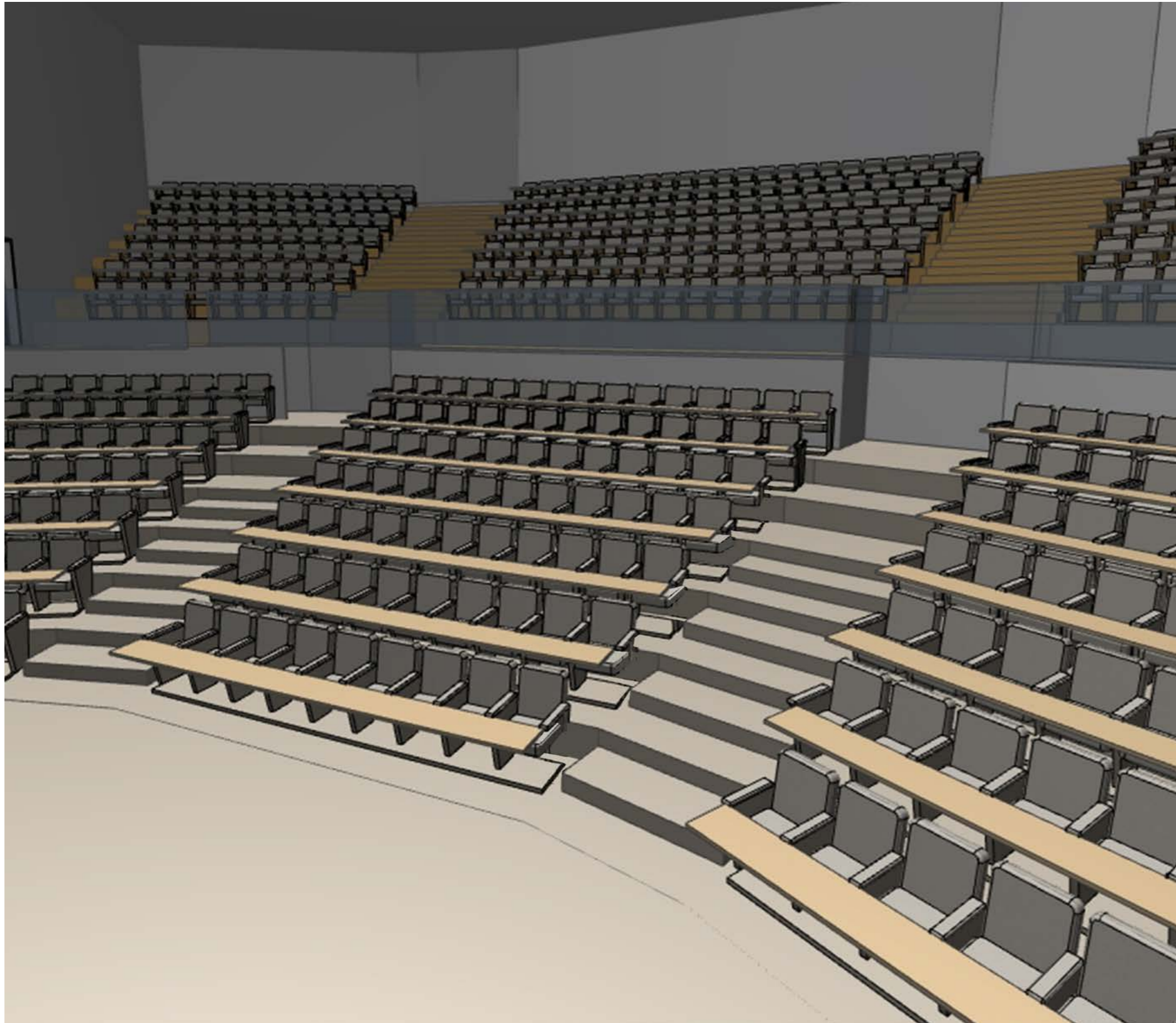

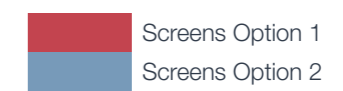
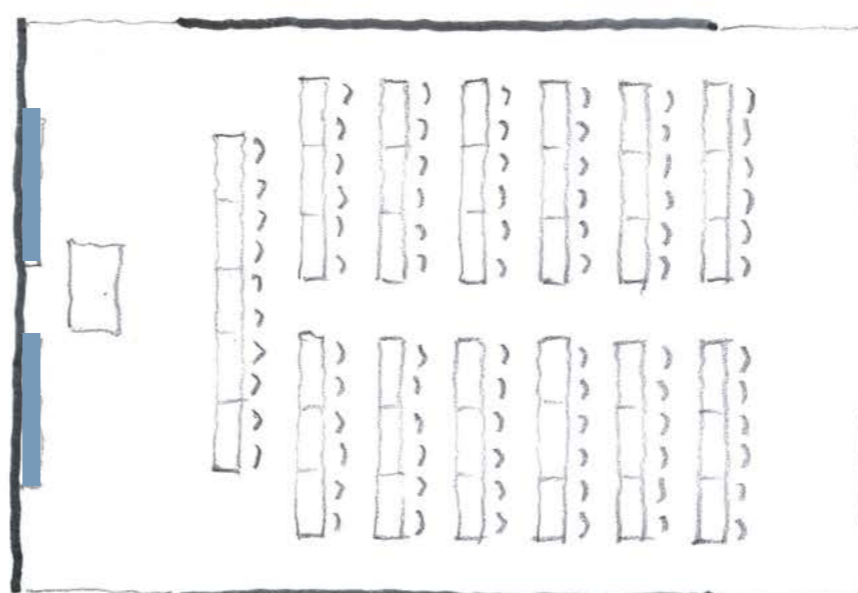
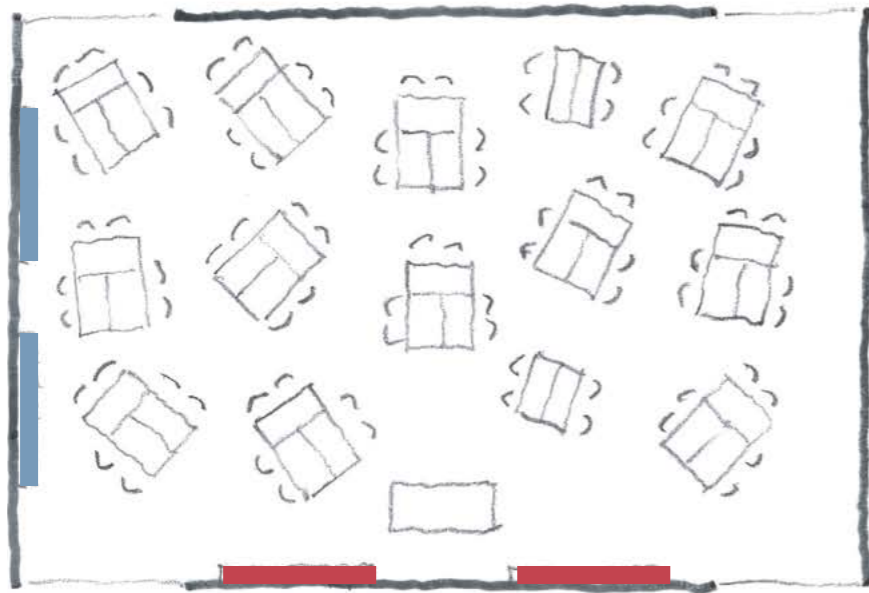
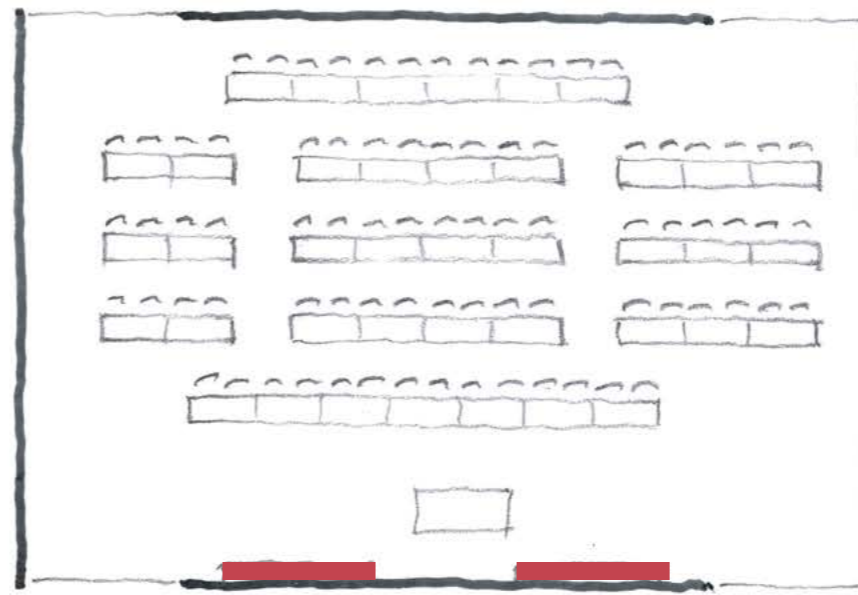
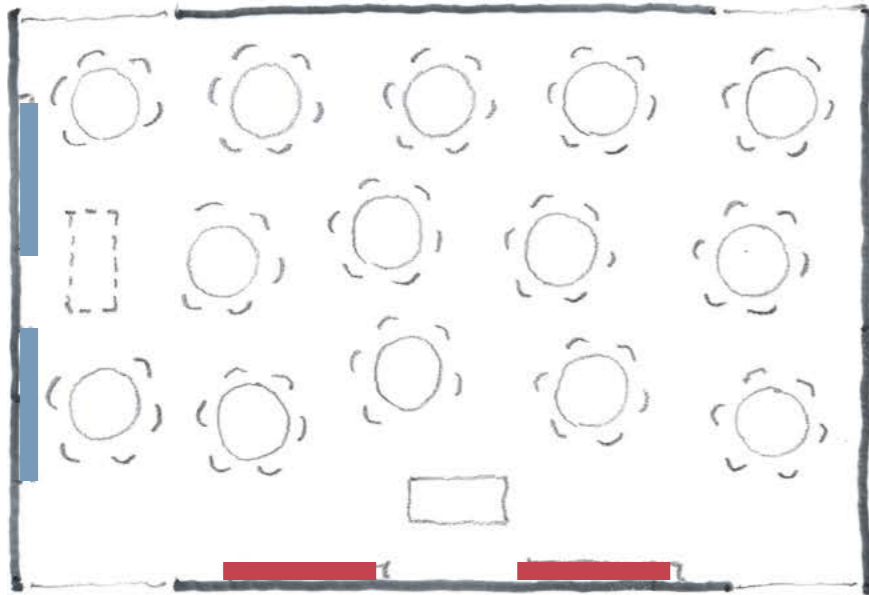

Variety of Layout Options for 80 Seat Room

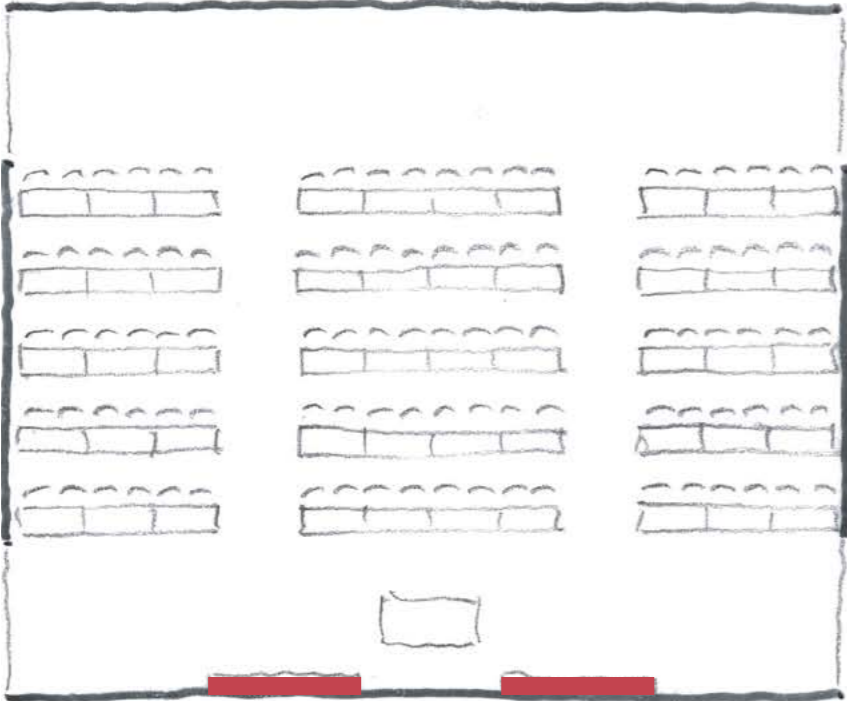
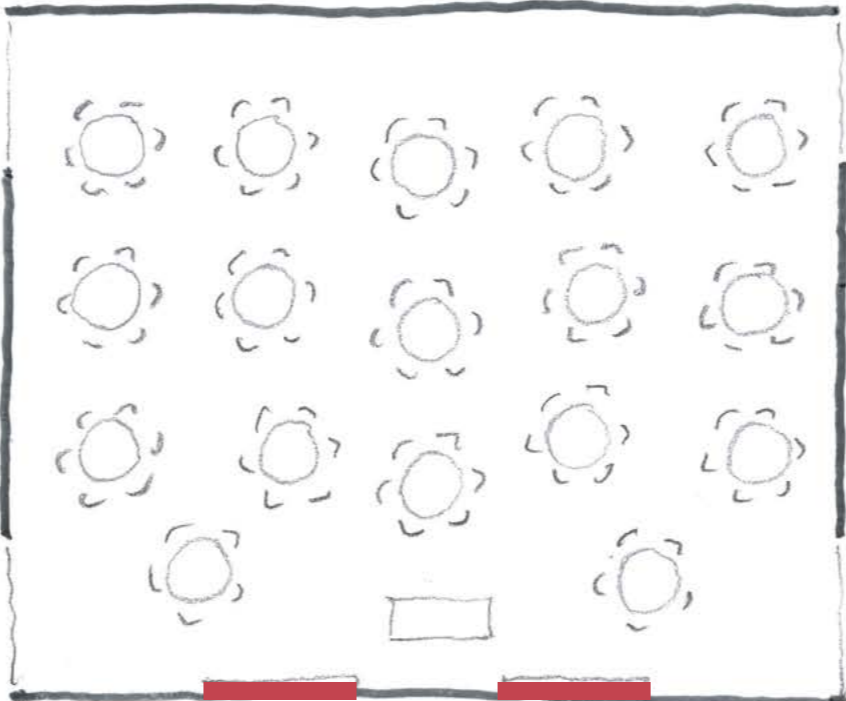
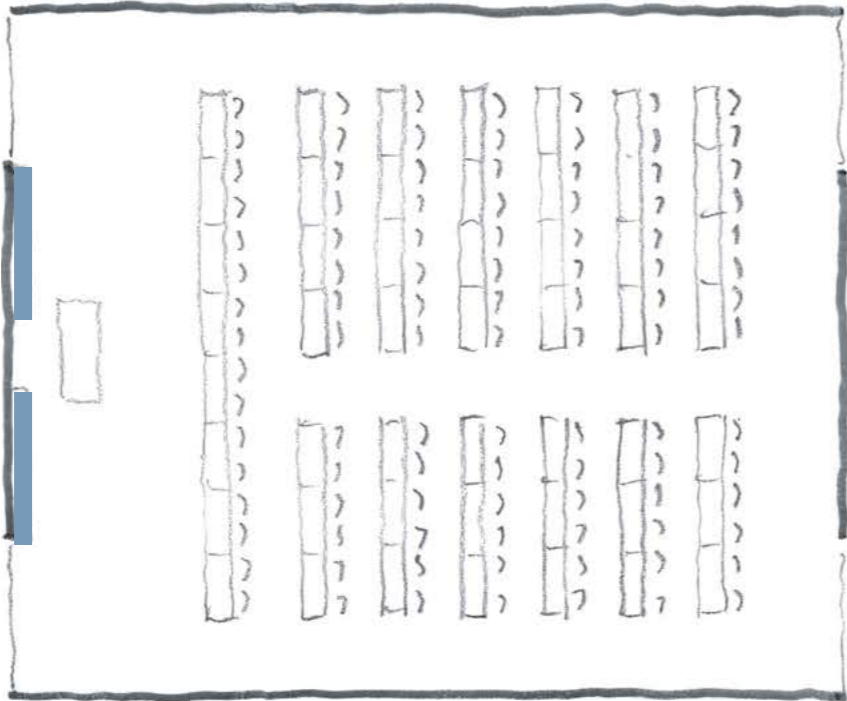

Variety of Layout Options for 100 Seat Room



 Screens Option 1
 Screens Option 2

Lecture Theatre Precedents



Queen's University, Belfast



Pembroke College, Oxford



The Ramphal Building, Warwick



Glasgow University

Lecture Theatre Precedents



Nottingham Trent University



Loughborough Design School



Queen Mary University, London



The Queens College, Oxford

Teaching Room Precedents



The Ramphal Building, Warwick



Loughborough Design School

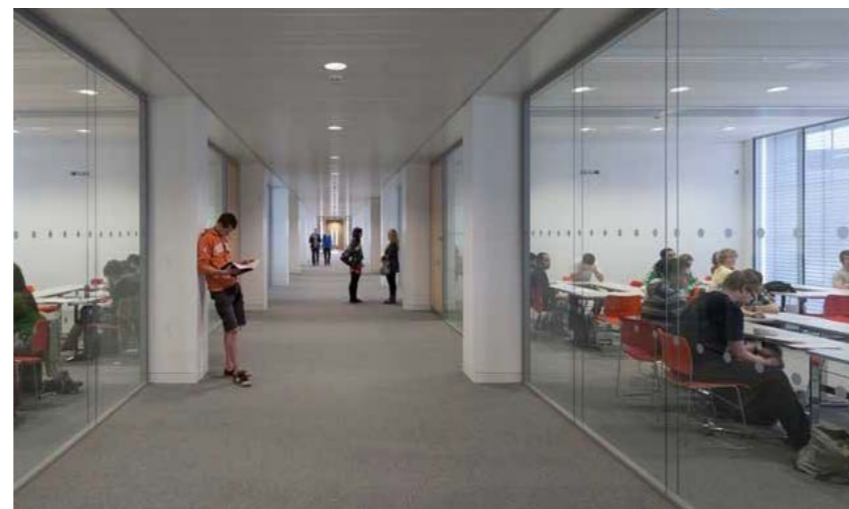

Nottingham Trent University



Duke University USA

Teaching Room Precedents



Loughborough Design School



University of Birmingham



Social Learning Spaces Precedents



University of Birmingham



Nottingham Trent University



Social Learning Spaces Precedents

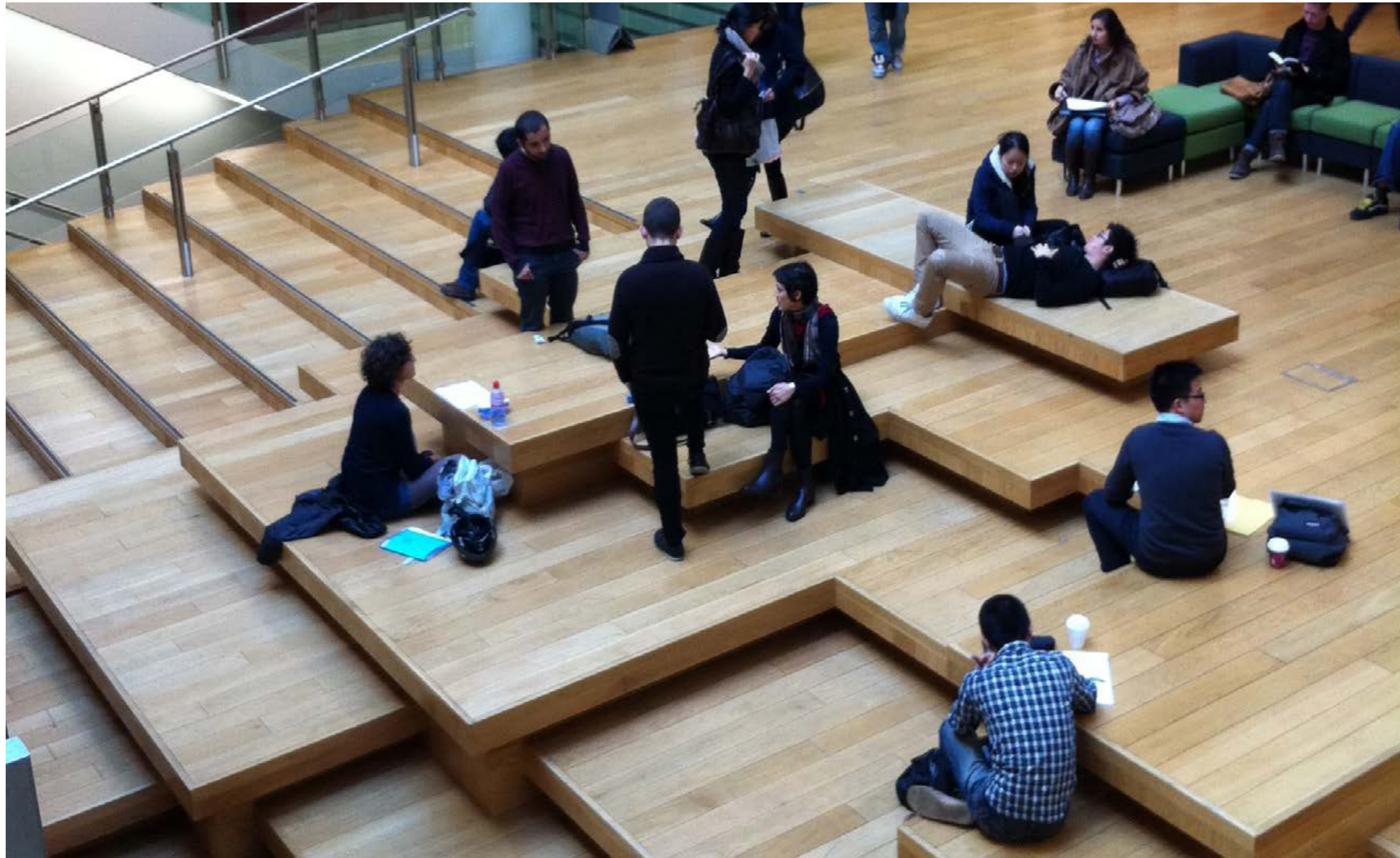

LSE



University of Queensland



Coventry University



Nottingham Trent University

Outdoor Spaces Precedents



UAL Central St Martins



St Catherine's College

